

**J. Davis Harte
Sample Syllabi**

DHE 387 – Studio III: Advanced Design Communication

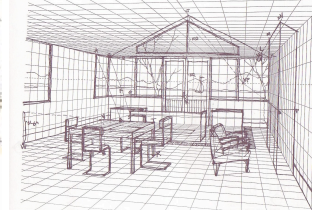
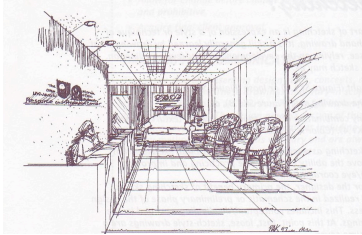

Term: Spring 2009
Instructor: J. Davis Harte
Office: Milam 37
Email: j.davisharte@gmail.com

Studio: M/W 8:00-10:50 AM
Office Hours: M: 11-12
W: 10:30-11:30
Phone: 541.520.6244

Course Description

4 credit hours. Development of illustrative sketching, perspective drawing, concept model construction, and presentation materials. PREREQ. DHE 287.

Blackboard Course Information

Students must have access to Blackboard in order to get announcements, assignments and grades.

Learning Objectives

At the end of this class, the student will be able to:

- Create, design, critique, and defend illustrative sketches (CIDA Standard 5 b).
- Critique and defend perspectives of 3-dimensional space and form (CIDA Standards 2 g, 4 b, 5 g).
- Develop detailed color and gray-scale renderings.
- Communicate project development through application of theories of design (CIDA Standard 3 c).

Course Materials:

Lin, M. (1993). Drawing and designing with confidence: A step by step guide.
Wiley: New York. Required.

Mitton, M. (2007). Interior design visual presentation (3rd ed.). Wiley: New York. Required.

Koenig, P. (2006). Design graphics; Drawing techniques for design professionals. (2nd ed). Upper Saddle River, NJ: Pearson Education, Inc. Optional.

NOTE: these texts are on 2-hour Reserve at the Valley Library.

Art supplies available at The Bookstore & Creative Crafts 934 NW Kings Blvd.

Copic Markers – equivalent is acceptable (may share)

! 0 Colorless Blender	! E51 Milky White	! B23 Phthalo Blue
! Neutral Gray 2	! E55 Light Camel	! B21 Baby Blue
! Cool Gray 4	! E34 Orientale	! B12 Ice Blue
! Cool Gray 6	! E25 Caribe Cocoa	! C2 Cool Gray No 2
! Warm Gray 2	! E37 Sepia	
! Warm Gray 4	! Y26 Mustard	The italicized pens are suggested by former students & may not be available in the kit.
! Toner Gray 2	! G82 Spring Green	
! E07 Light Mahogany	! G28 Ocean Green	
! E13 Light Suntan	! BG99 Fragstone Blue	

Prismacolor Pencils –this list is the ideal. You may choose selectively & you may share.

! PC938 White	! 944 Terra Cotta	! 1012 Jasmine
! PC935 Black	! 927 Light Flesh	! 937 Tuscan Red
! PC1050 Warm Gray 10%	! 914 Cream	! 922 Poppy Red
! PC1051 Warm Gray 20%	! 942 Yellow Ochre	! 932 Violet
! PC 1054 Warm Gray 50%	! 943 Burnt Ochre	! 908 Dark Green
! PC1074 French Gray 70%	! 945 Sienna Brown	! 902 Ultramarine Blue
! Cool Gray 10%	! 940 Sand	! 911 Olive Green
! PC1063 Cool Gray 50%	! 941 Raw Umber	! 1022 Mediterranean Blue
! PC1065 Cool Gray 70%	! 931 Purple	! 907 Peacock Green
! 946 Dark Brown	! 915 Lemon Yellow	! 912 Apple Green

Paper

- ! 18 in. x 50 yards tracing paper roll
- ! Manga or similar Marker Paper 11x14
- ! 892 Bogus Rough Sketch 9x11 (may share)

Drawing pen

- ! Stabilo Point 88
- ! Sharpie Extra Fine Point

Assignments

In-class Sketching & Critique

Each Monday students will bring in 2 photographs of interior environments. May be of either residential or commercial spaces, but interior design majors must use a majority of non-residential photographs. From 8-9:30 students will sketch these interior photographs in class using the assigned media. At 9:45 we will have a critique of sketches in which everyone participates with comments. Wednesdays will include sketching as well as lecture demonstrations and work on the projects.

The in-class sketching/critique assignments are required participation for all students. If students are absent, they will be expected to complete the sketches by the next class day for credit. However, full credit will not be given because students will not have participated in the critique process. It is the responsibility of the student to determine what sketches were missed.

In-class quizzes

There will be quizzes on the assigned chapters from the two textbooks.

Baseline lettering & final lettering

In-class lettering on first day of class & during the final week. Improvement expected.

Portfolio-ready scans

Scan your projects and sketches, according to guidelines list, for your portfolio.

Clippings file

Make an organized & tidy file of various common images (i.e. furniture & textures).

Principles of Good Graphics (PGG) tables

From the Lin textbook, create a reference sheet of the principles of good graphics.

Kearney 'live' sketch

Render a building from an actual visit to the site.

Project #1

From a floor plan drawing of a room of your choice, you will develop a one-point perspective drawing.

Project #2

Develop a 2-point perspective of the space. Scans of work (as indicated on separate guidelines) are due when this project is presented. Email them to the instructor.

Project #3

Select a floor plan of a small commercial interior space or residence. The plan will be color rendered with 4 additional color elevations. Development will include color studies.

Project #4

Students will develop 2 versions of a color-rendered perspective of a space incorporating unique design ideas in the spaces. Development will include color studies.

Course Grading and Evaluation

In-class sketches & critiques (10 each)	100
Lettering before/after	10
Clippings file	10
In-class quizzes on texts	30
PGG tables 1 & 2	20
Kearney 'live' sketch	30
Project #1 – One-point perspective	75
Project #2 – Two-point perspective	75
Project #3 – Color rendered plan & elevations	100
Project #4 – Color rendered perspective	100
Portfolio-ready scans: mid-term	25
Portfolio-ready scans: final	25
Total:	600 points

Grading

A	94-100%	B-	80-82%	D+	67-69%
A-	90-93%	C+	77-79%	D	63-66%
B+	87-89%	C	73-76%	D-	60-62%
B	83-86%	C-	70-72%	F	Below 60%

Tentative Course Schedule

NOTE: four-credit classes require 8-12 hours per week outside class.

Date	Studio & assignments		Readings
Week 1:	M: 3/30	In-class sketching	Lin: Ch 1, 2, 3, 8 Mitton: Ch 4
	W: 4/1	Project #1 assigned	
Week 2:	M: 4/6	In-class sketching PGG table # 1 due	Lin: Ch 4-5
	W: 4/8	Project #1 work time Quiz 1	
Week 3:	M: 4/13	In-class sketching Clippings file (phase 1) due	Lin Ch 9
	W: 4/15	Present Project #1 Project #2 assigned	
Week 4:	M: 4/20	In-class sketching	Mitton: Ch. 3, 5
	W: 4/22	Project #2 work time Quiz 2	
Week 5:	M: 4/27	In-class sketching	Mitton: Ch. 7, Lin: Ch 6
	W: 4/29	Present Project #2 Project #3 assigned	
Week 6:	M: 5/4	In-class sketching	
	W: 5/6	Project #3 work time Quiz 3	
Week 7:	M: 5/11	In-class sketching PGG table #2 due	
	W: 5/13	First scans due Present Project #3	
Week 8:	M: 5/18	In-class sketching	
	W: 5/20	Project #4 work time	
Week 9:	M: 5/25	No-class Memorial Day	
	W: 5/27	Project #4 – show all color studies for critique & reflection	
Week 10:	M: 6/1	In-class sketching Kearney bldg 'live' sketch due	
	W: 6/3	Present Pr #4 (scan first)	
Week 11:	M: 6/8	Final scans due Monday, noon. No final exam.	
		Thanks for a giving your best effort all term!	